



# Instruction: Coupling Service Plastic Strip



Needed: new coupling, port plug or port cover, small amount of white grease (Dow 112), a pointed pin, pliers or channel locks. (cup seal and lockout ball if needed) (Puller Tool THA401, available from TFT if needed).



1) Remove port plug or port cover.



2) If coupling is not locked-out, swivel coupling around until the end of the plastic strip can be seen.

If coupling is locked-out end of plastic strip will be in position for removal.



3) Insert puller tool (available from TFT Part Number: THA401) into coupling as shown and hook the end of the plastic strip



4) Pull plastic strip out gently so that the end of the plastic strip does not break off.

**Locked out coupling:** Rock coupling back and forth while pulling with tool.

**Swivel coupling:** Rotate coupling in opposite direction while pulling with tool.



5) Once one to two inches of the strip is exposed pull with pliers or channel locks.



6) Remove existing coupling, cup seal (if present) and lockout ball (if present).

7) Clean plastic strip groove to remove any dirt or debris.

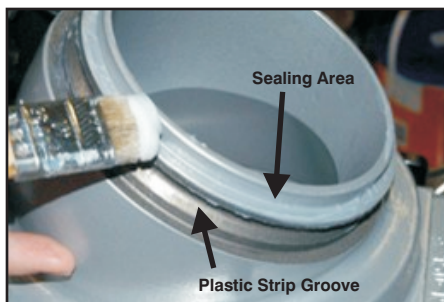

8) Re-grease plastic strip groove and sealing area using Dow 112.



9) Grease plastic strip groove and sealing area in new coupling using Dow 112.

**TASK FORCE TIPS, INC.**  
www.tft.com

2800 East Evans Avenue, Valparaiso, IN 46383-6940  
800-348-2686 • 219-462-6161 • Fax 219-464-7155

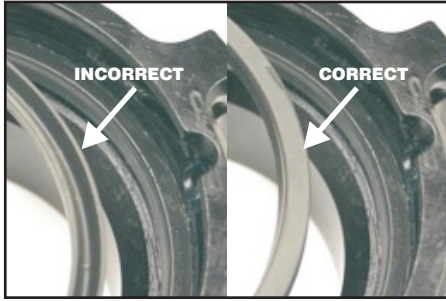

10) Grease cup seal, if used, with Dow 112 and install into coupling with sealing lips down (away from you).

**Note: direction of sealing lips face down into coupling.**

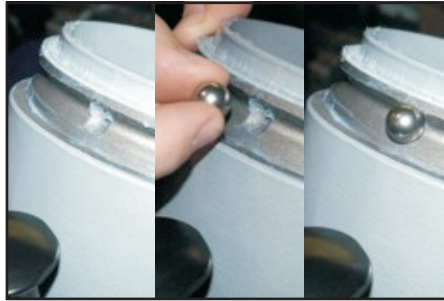

11) Install locking ball if required



12) Push new coupling on until it stops.  
**Note alignment of lockout ball detail.**



13) Push new plastic strip into port.

**Note: Hooked end goes in last.**

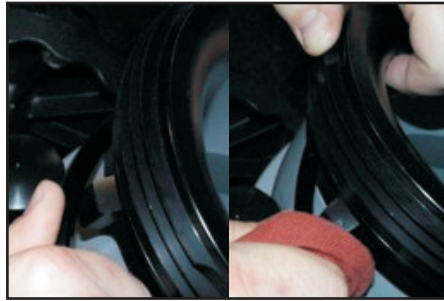

14) Make sure plastic strip is all the way in.

Use a T-handle Allen wrench to push the strip the rest of the way into the strip channel.

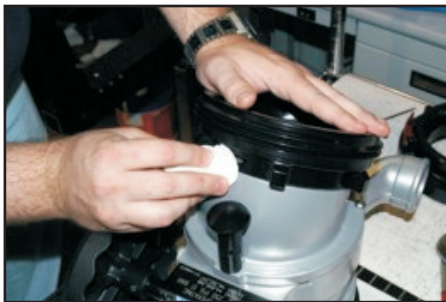

15) Clean dirt, debris, and grease off of coupling.



16) Install port plug or port cover.