

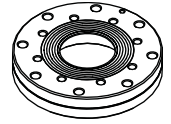

# Installation Instructions: AA9FP-FX Adapter 4.0" ANSI 150 x 6.0" ANSI 150



*This flange adapter is intended to adapt a monitor with 4" ANSI 150 inlet flange to a standpipe with a 6" ANSI 150 flange or vice versa. Read monitor installation manual to verify all requirements are met.*

## ⚠ WARNING

Injury can result from an inadequately supported monitor. The structure to which the monitor is mounted must be capable of withstanding the internal pressure of the monitor as well as shear and bending forces due to nozzle reaction. Nozzle reaction can be as high as 1500 lbs (680 kg) (2000 gpm at 200 psi, 1600 gpm at 300 psi). Flanges and pipe made from plastic are inadequate for monitor mounting and must not be used.

### Installation Instructions:

Note\* Gaskets and hardware not included.

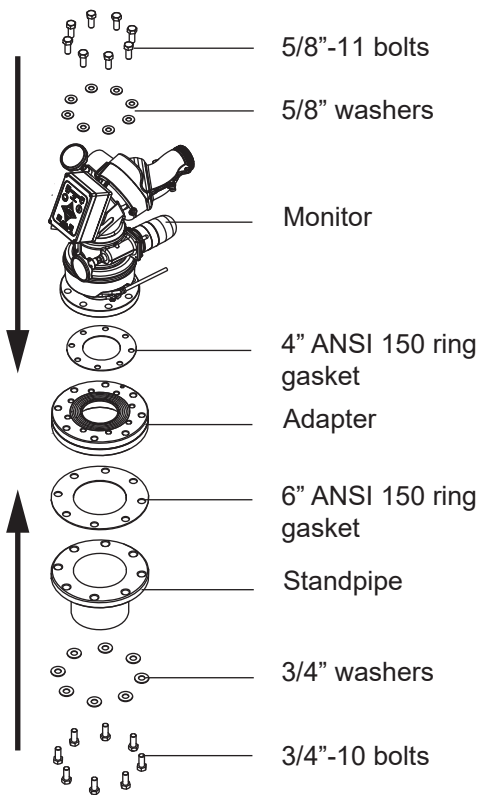

**Step 1** Align holes and check clearance for both standpipe and monitor.

**1**

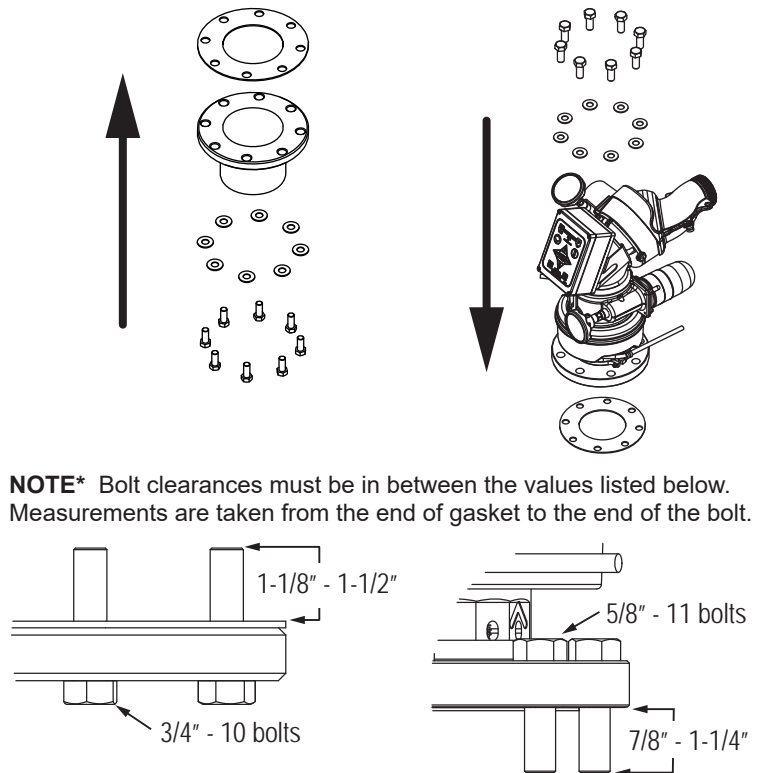

**Step 2** Apply 1" stripe of Loctite 242 (blue) to all (5/8"-11, 3/4"-10) bolts and install finger tight through flanges into adapter as shown above.

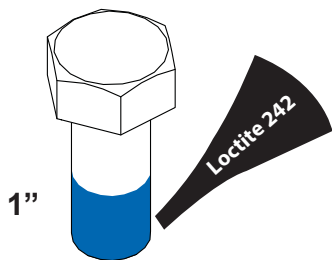

**Step 3** Tighten the bolts/nuts in the alternating sequence shown below. Tighten sequentially each bolt three times to the values listed in the table below.

### Tightening Sequence

#	5/8" -11	3/4" - 10
<b>1</b>	24 ft-lb 33 N-m	44 ft-lb 60 N-m
<b>2</b>	48 ft-lb 66 N-m	88 ft-lb 120 N-m
<b>3</b>	78 ft-lb 105 N-m	138 ft-lb 187 N-m

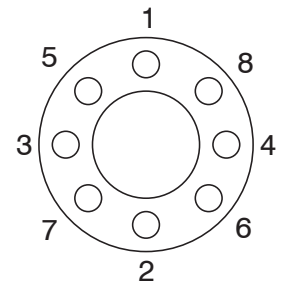

**TASK FORCE TIPS, INC.**  
MADE IN USA • www.tft.com

3701 Innovation Way, Valparaiso, IN 46383-9327 USA  
800-348-2686 • 219-462-6161 • Fax 219-464-7155