

Low Profile, Low Loss, AND Low Cost . . .



*This Low-Profile Intake Valve
is Developed for
Maximum Performance*

. . . REALLY !

Available in manual or remote controlled variations, the low-profile jumbo waterway design of these intake valves provides maximum flow with little friction loss. Carrying an exclusive 10-year warranty from corrosion, and measuring less than 29 cm deep,

these valves are the perfect choice for compact pump panel designs. The ideal alternative to intake valves integrated into the apparatus pump system, never again will an apparatus need to be taken out of service for repair or maintenance of an

intake valve. Lightweight coated aluminum alloys are used throughout, and when combined with a remote valve controller at the pump panel, this valve is the perfect choice for remote operations.



TASK FORCE TIPS
Made in USA • www.tft.com

3701 Innovation Way, Valparaiso, IN 46383-9327 USA
US & CN 800.348.2686 • 1.219.462.6161 • fax 1.219.464.7155



Jumbo Low Profile Ball Intake Valve RC, shown here with optional Remote Control Panel and Wiring harness



JUMBO LOW PROFILE BALL INTAKE VALVE RC

AXD Series – The Jumbo Low Profile Ball Intake Valve RC is an electric remote controlled valve with all the benefits of TFT’s Jumbo Low Profile Ball Intake Valve with the addition of powered operation. A large knob is installed on the drive shaft for immediate manual override. Designed for 12 or 14 VDC operation, selection is automatic. The motor control circuit uses an encoder and current limiting to protect the drive train at the ends of travel. The panel mounted control box allows for remote operation and contains an LED display showing valve position. Unit comes with a panel mounted quick- connect plug for connection between the valve and control box. Electric drive and control box are waterproof. Mechanical installation consists of attaching the valve to the pump, mounting the control box and quick-connect electric plug. Six seconds from open to close, meets NFPA 1901 slow close requirement. The valve is designed for pressure or vacuum service. Maximum operating pressure is 250 psi (17 bar). Meets 900 psi (62 bar) hydrostatic strength test. A rugged ¼-turn Air Vent at the top of the valve allows air to be bled quickly. TFT’s adjustable Pressure Relief Valve (PRV) is installed with the discharge pointing downward and meets NFPA 1901 (2009 Edition). The aluminum castings are hardcoat anodized, and TFT powdercoated finished inside and out for maximum corrosion protection. All wetted components are aluminum alloys to prevent galvanic corrosion, and are specially coated for additional corrosion protection. Hose coupling and truck connections are attached to the valve using polymer bearing rings which can provide electrical isolation to help prevent galvanic corrosion. The Jumbo Low Profile Ball Intake Valve RC is covered by a 10 year warranty. Contact TFT customer service for configurations not shown. Friction loss is 5 psi at 2000 gpm.

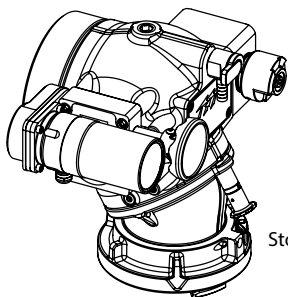

Storz Coupling Shown

AXD1 & AXD3 SERIES

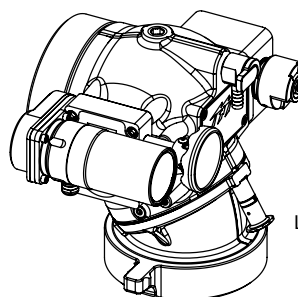

Long Handle Coupling Shown

AXD7H SERIES

**Dimensional Maximum
AXD7H-NX-NX-RC**
30.5 lbs (13.8kg)
12.3" (31.2cm) Height
15.6" (39.6cm) Width
11.3" (28.7cm) Depth

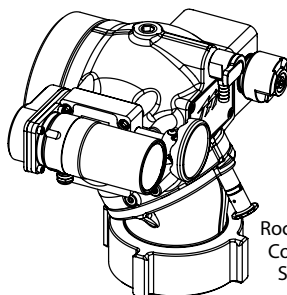

Rocker Lug Coupling Shown

AXD7 SERIES

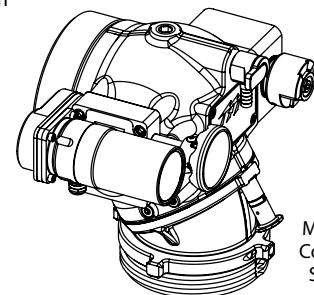

Male NH Coupling Shown

AXD8 SERIES

Visit www.tft.com to learn more.