

Instruction: Coupling Service Polymer Strip

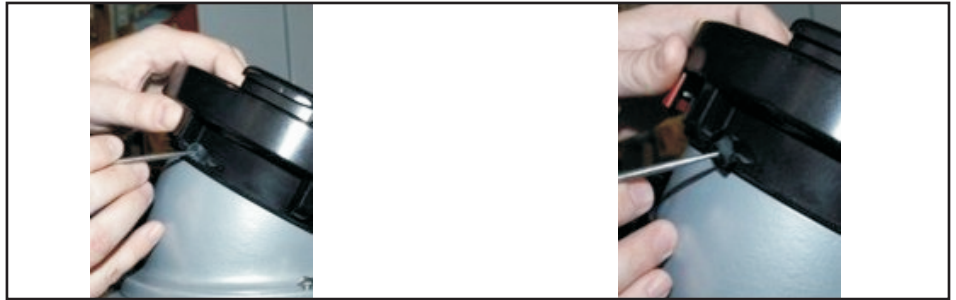

Items required: Required for Coupling change: Replacement coupling, port plug or port cover, Dow 112 grease, pointed pin/seal pick, pliers, polymer strip removal tool THA401, cup seal and lockout ball. All items are supplied in our coupling replacement kits.



Step #1) Using the seal pick or pointed pin, remove the port plug or port cover, which is used to cover the access port to the polymer ring.



Step #2) If the coupling swivels, rotate till the end on the polymer ring can be seen through the access port. The ring can also be moved with the seal pick if required.

If the coupling does not rotate, it is locked out with a stainless steel ball (Photo #9). The end of the polymer ring will be in position for removal.



Step #3) Insert THA401 into port as shown, with hook side up. Engage with polymer ring.



Step #4) Pull the polymer strip out gently so the end of the strip does not break off.

It may help if the coupling is rocked back and forth or rotated.



Step #5) Once the strip is exposed by several inches you may remove using pliers.



Step#6) Remove coupling, cup seal and lock out ball if present.

Step #7) Clean entire exposed surface of any remaining grease and debris.

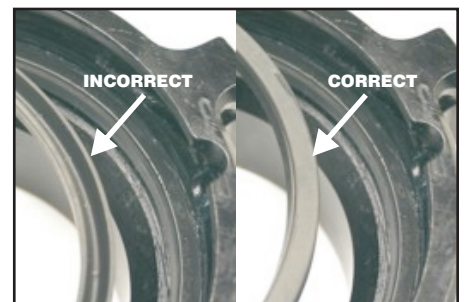

Step #8) Install cup seal as shown above. Apply grease to the cup seal only.

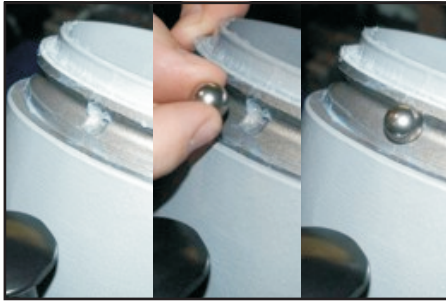

Step #9) If desired, install lock out ball. Apply a small amount of grease to the ball pocket to help retain the ball in position.



Step #10) Push coupling on completely. If lock out ball is being used, note alignment.

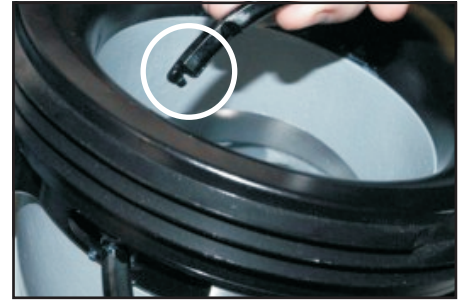

Step #11) Insert polymer ring into the port with the blunt end first.

(Note: Hook end goes in last.)

When inserting in a Storz coupling, spray the polymer ring with BreakFree before assembly.

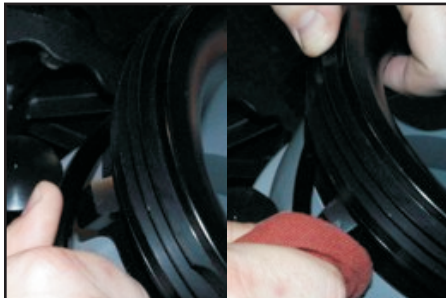

Step #12) Install polymer ring fully. The THA401 may be used to insert the strip the last 2 inches.

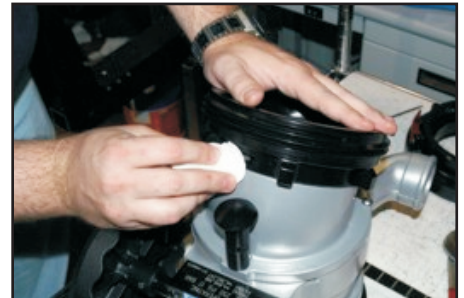

Step #13) Use a degreaser to clean the area of the port is the cover type is used. Use short end of the THA401 to assist in the installation of the port plug. Install till flush.

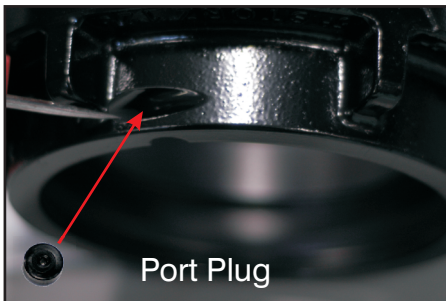

Step #14) Install port plug or port cover.

TASK FORCE TIPS, INC.
www.tft.com

3701 Innovation Way, Valparaiso, IN 46383-9327
800-348-2686 • 219-462-6161 • Fax 219-464-7155